

SIGN	DATE	DESCRIPTION	APPROVER
△	10/14/08	將Body底部方槽改為φ3.0圓孔形	Kind
△	09.4.13	Current, wire range, approval are changed	JODY
△	10/23'12	Change the screw plating specification	Jacky
△	10/23'12	Change the dimensional tolerance	Jacky
△	10/23'12	Add the dimensional label	Jacky

*THIS IS CAD DRAWING, DO NOT REVISE MANUALLY!!!*

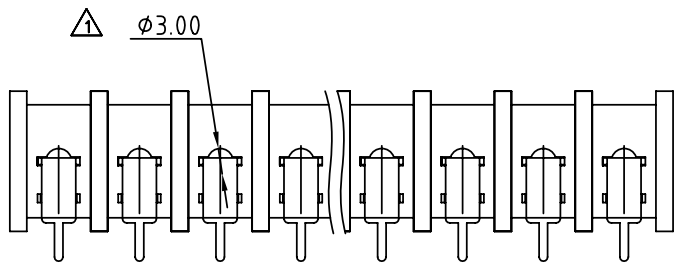
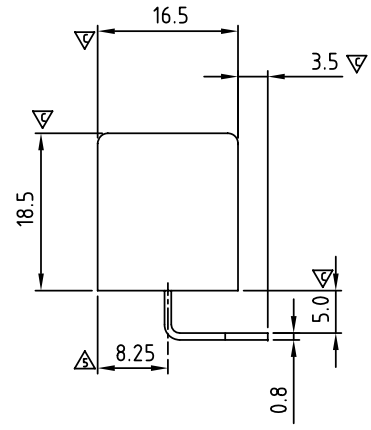
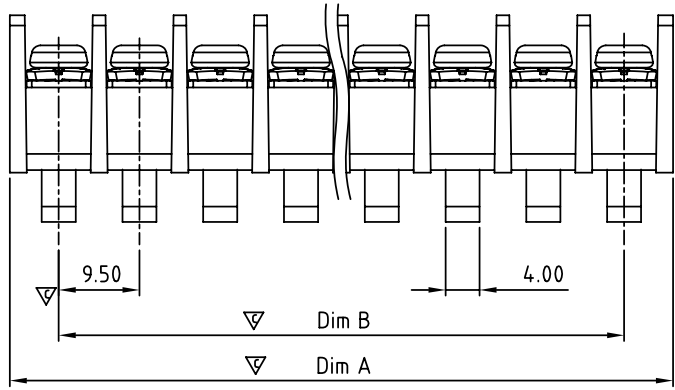
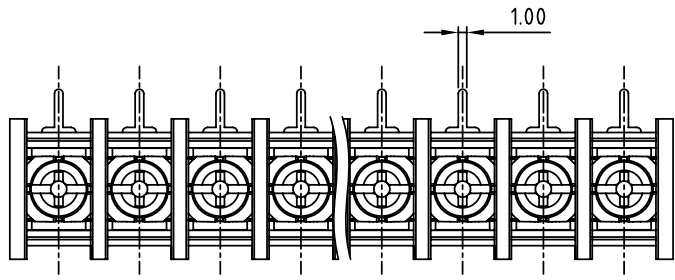

Dimension A&B

DIM A	N×9.5+2.0
DIM B	(N-1)×9.5

N=Number of contacts

Dimension A&B	Tolerance
>6 -30	±0.30
>30 -120	±0.40
>120-400	±0.60

MATERIALS ELECTRICAL  
 RATED VOLTAGE & CURRENT: 300 V, 30A △  
 WITHSTAND VOLTAGE: AC 2000 V/Min  
 INSULATION RESISTANCE: 1000 MΩ OR MORE AT DC 500 V  
 OPERATING TEMPERATURE RANG: -40 °C ~ +115 °C  
 SCREW TORQUE VALUE: 8.8 Lb-in.  
 WIRE RANGE: 10-22 AWG △  
 1) MOLDED PARTS: THERMOPLASTIC, UL 94 V-0 BLACK  
 2) TERMINAL: BRASS, 0.8t, Tin PLATED  
 3) TERMINAL SCREWS: STEEL, M3.5  
 APPROVAL: US  
 PART NO.:  
 Critical dimension: ▽

**YK 513 xx 0 x x 00G**

- NO. OF POLES: 02: 2 POLES, 03: 3 POLES, 04: 4 POLES, ... 30: 30 POLES
- MARK: 0: "@ " MARK, 1: "ANY " MARK
- TERMINAL & SCREW PLATED: 0: TERMINAL & SCREW: G/F, 1: TERMINAL: G/F, SCREW: Zinc, 2: TERMINAL: Sn, SCREW: G/F, 3: TERMINAL: Sn, SCREW: Zinc
- G: RoHS compliant (lead<4%) in copper alloy

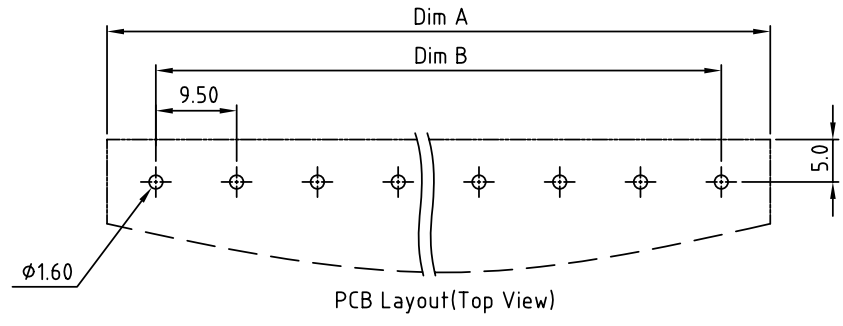

<b>ANYTEK</b>				<b>CUSTOMER COPY</b>			
TITLE		YK-513 W/O Flange Series					
PART NO.		YK513xx0xx00G		DWG NO.		8YK0001-513	
APPROVED		CHECKED	DESIGNED	DRAWN	CUST NO.		Tolerance
			Jacky 2012.10.23	Jacky 2012.10.23			X. ±0.50 X.X ±0.30 X.XX ±0.10 X° ±1°
		SHEET: 01/01		REV.: F			