

SuperTSS –Thyristor Surge Suppressor

1. Features

- Excellent capability of absorbing transient surge
- Eliminates overvoltage caused by fast rising transients
- Quick response to surge voltage (ns Level)
- Bi-directional
- Non degenerative
- Rating Surge Voltage: 2KV (10/700µs)

2. Application Information

- RS485/232/422

3. Ordering Information

| Part Number | Package | Marking | Material | Packing | Quantity per reel | Flammability Rating | Reel Size |
|-------------|----------|-----------|--------------|-------------|-------------------|---------------------|-----------|
| ES0300TAS | SOD123-F | 30TAS/LOT | Halogen free | Tape & Reel | 3,000 PCS | UL 94V-0 | 7 inches |

Table-1 Ordering Information

4. Package information



| Outline | Circuit Diagram |
|---|---|
|  |  |

Table-2 Package information

5. Part Number and Electrical Parameter

Absolute maximum ratings measured at $T_A = 25^\circ\text{C}$ RH = 45%-75% (unless otherwise noted).

| Part Number | $I_{DRM} @ V_{DRM}$ | | $V_S^{①} @ I_S$ | | $V_T @ I_T$ | | I_H | | $C_o^{②}$ |
|-------------|---------------------|----|-----------------|-----|-------------|-----|-------|-----|-----------|
| | μA | V | V | mA | V | A | mA | | pF |
| | MAX | | MAX | | MAX | | MIN | MAX | TYP |
| ES0300TAS | 5 | 25 | 40 | 800 | 4 | 2.2 | 20 | 150 | 60 |

Table-3 Part Number and Electrical Parameter

NOT:

- ① V_S is measured at 100KV/S
- ② Off-state Capacitance is measured at $V_{DC}=2V, V_{RMS}=1V, f=1\text{MHz}$

6. V-I Curve

| Parameters | Definition |
|------------|------------------------|
| V_{DRM} | Peak Off-state Voltage |
| I_{DRM} | Off-state Current |
| V_S | Switching Voltage |
| I_S | Switching Current |
| I_H | Holding Current |
| V_T | On-state Voltage |
| I_T | On-state Current |
| C_o | Off-state Capacitance |

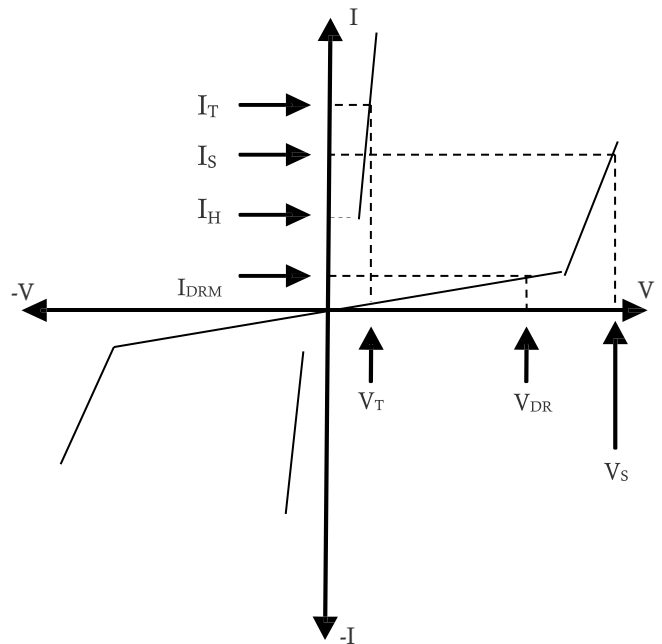

7. Surge Ratings

| | | | |
|------------------|----------------|-----------------|-----------------|
| Current Waveform | 8/20 μ s | 5/320 μ s* | 10/1000 μ s |
| Voltage Waveform | 1.2/50 μ s | 10/700 μ s* | 10/1000 μ s |
| I _{pp} | 90A | 50A | 35A |

Table-4 Surge Ratings

-Peak pulse current rating (IPP) is repetitive and guaranteed for the life of the product;

-Elecsuper only makes the test for 5/320 μ s @50A*(10/700 μ s 2KV,40 Ω), but for other IPP value derived from experience is just for reference only. Elecsuper will not take any obligation for these parameters, so before applying our parts, please make sure to verify the parameters listed in the above table.

8. Thermal Considerations

| Symbol | Parameter | Value | Unit |
|----------------|--------------------------------------|-------------|------|
| T _J | Operating Junction Temperature Range | -40 to +150 | °C |
| T _S | Storage Temperature Range | -55 to +150 | °C |

Table-5 Thermal Considerations

9. Typical Characteristics

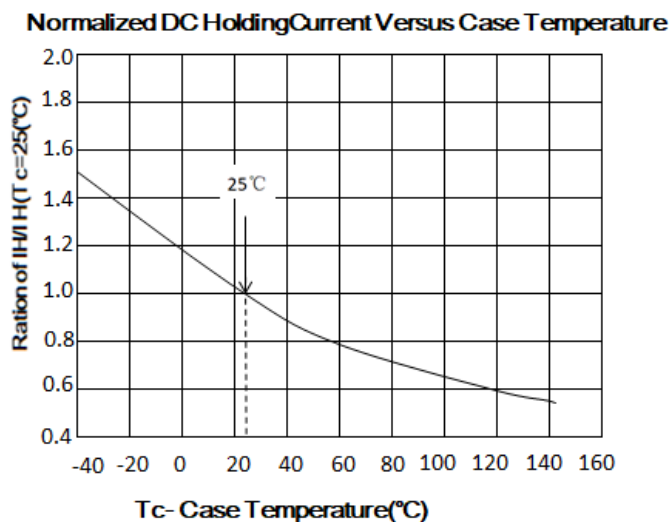
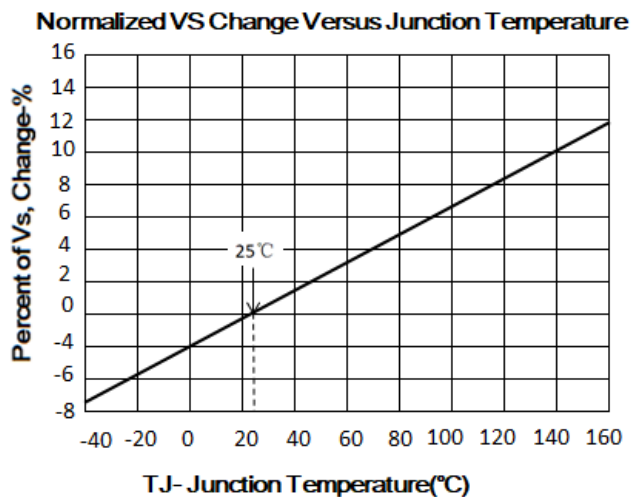
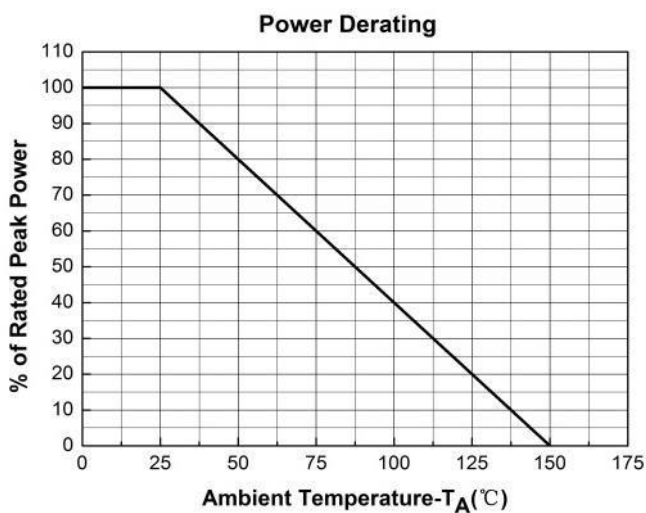
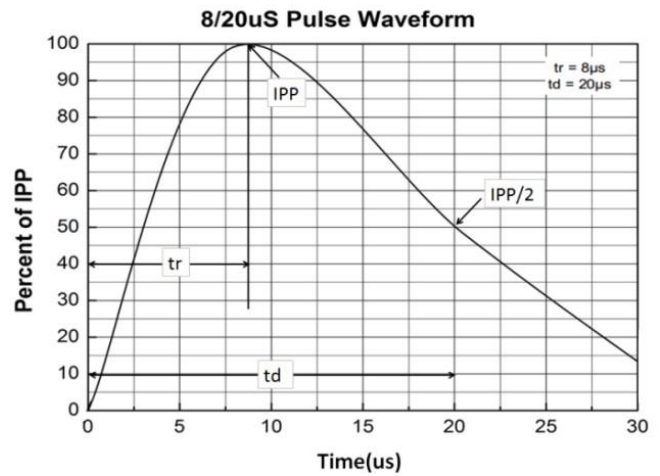
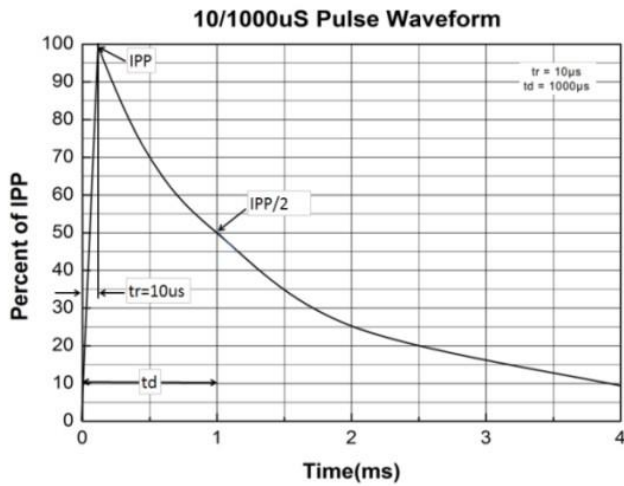

10. Dimension (SOD123-F)

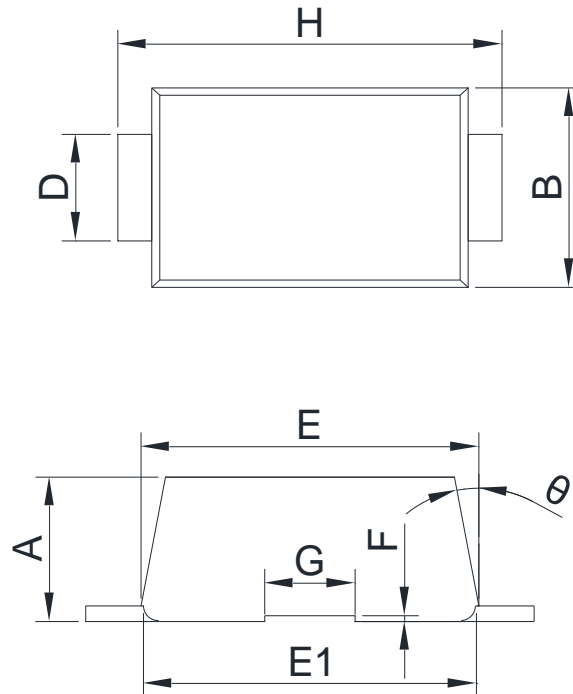

| REF | Millimeters | | REF | Millimeters | |
|-----|-------------|------|-----|-------------|------|
| | MIN | MAX | | MIN | MAX |
| A | 1.05 | 1.25 | F | -0.15 | 0.05 |
| B | 1.70 | 1.90 | G | 1.10 | 1.30 |
| D | 0.90 | 1.10 | H | 3.60 | 3.80 |
| E | 2.90 | 3.10 | θ | 6° REF | |
| E1 | 2.85 | 3.05 | | | |

DISCLAIMER

ELECSUPER SUPERTVS PROVIDES TECHNICAL AND RELIABILITY DATA (INCLUDING DATASHEETS), DESIGN RESOURCES (INCLUDING REFERENCE DESIGNS), APPLICATION OR OTHER DESIGN ADVICE, SAFETY INFORMATION, AND OTHER RESOURCES "AS IS" AND WITH ALL FAULTS, AND DISCLAIMS ALL WARRANTIES, EXPRESS AND IMPLIED, INCLUDING WITHOUT LIMITATION ANY IMPLIED WARRANTIES OF MERCHANTABILITY, FITNESS FOR A PARTICULAR PURPOSE OR NON-INFRINGEMENT OF THIRD PARTY INTELLECTUAL PROPERTY RIGHTS.

These resources are intended for skilled developers designing with ElecSuper products. You are solely responsible for

- (1) selecting the appropriate ElecSuper products for your application;
- (2) designing, validating and testing your application;
- (3) ensuring your application meets applicable standards, and any other safety, security, or other requirements.

These resources are subject to change without notice. ElecSuper grants you permission to use these resources only for development of an application that uses the ElecSuper products described in the resource. Other reproduction and display of these resources are prohibited. No license is granted to any other ElecSuper intellectual property right or to any third party intellectual property right. ElecSuper disclaims responsibility for, and you will fully indemnify ElecSuper and its representatives against, any claims, damages, costs, losses, and liabilities arising out of your use of these resources. ElecSuper's products are provided subject to ElecSuper's Terms of Sale or other applicable terms available either on www.elecsuper.com or provided in conjunction with such ElecSuper products. ElecSuper's provision of these resources does not expand or otherwise alter ElecSuper's applicable warranties or warranty disclaimers for ElecSuper products.