

REV.	ECN NO.	DESCRIPTION	DATE	DESIGN

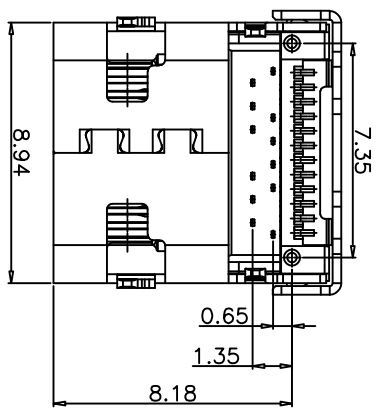

NO.	PART NAME	MATERIAL	FINISH
1	HOUSING	LCP	BLACK, UL 94V-0
2	CONTACTS	C7025 TM03	Contact area: Ni:50u", Au 1u"; Solder area: Ni:50u", Au G/F; Other area: Ni:50u";
3	OUTER SHELL	SUS 304	Ni:30u"Min.
4	MID-PLATE	SUS 301	CLEAN
5	GROUND	SUS 304	CLEAN

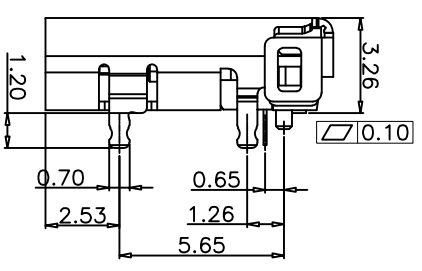
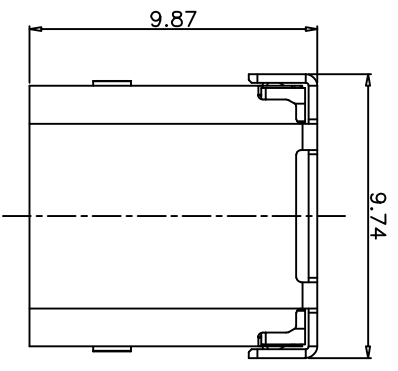
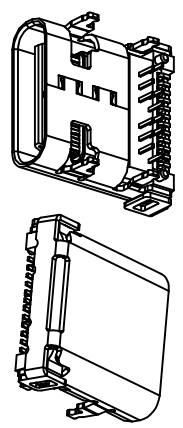
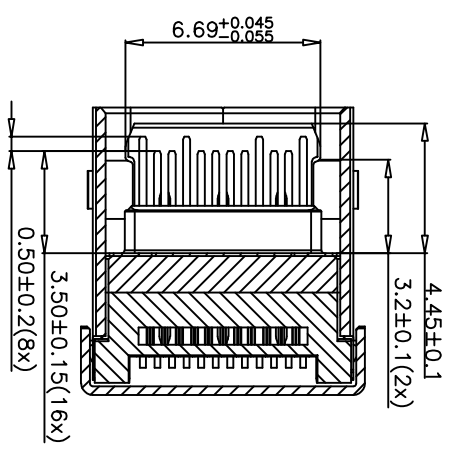
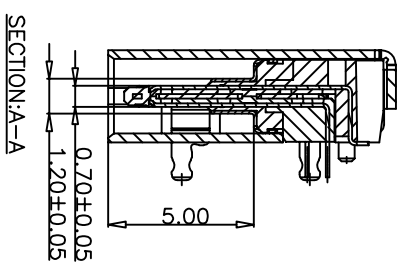
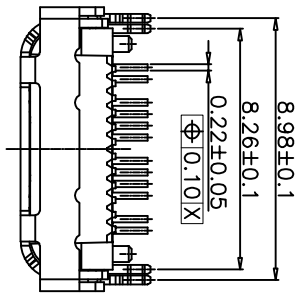
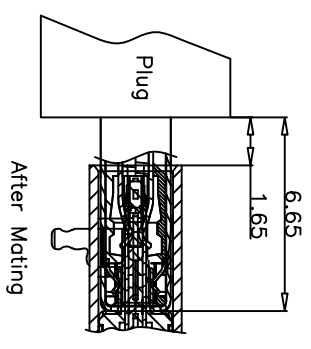
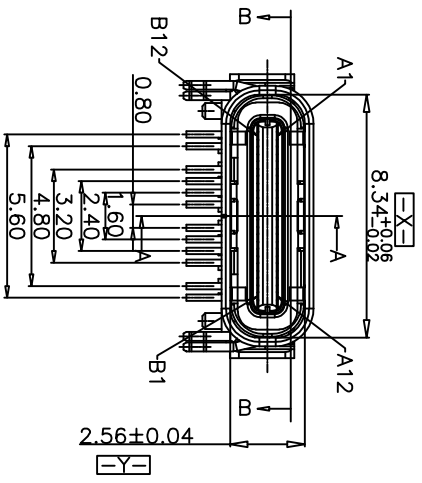

TOLERANCE	NAME (INTENDED USE)	TITLE:
X.X ±0.30 X.X' ±10°	PART NO.	FY23-68TC24F1987-250
.XX ±0.20 .X' ±8°	CUSTOMER DRAWING	USBS. 0 TYPE-C24P 立贴8.8 高频80G
.XXX ±0.10 .XX' ±5°	DESIGN: ZXM	
UNITS mm	CHED:	
MATERILA	APPD:	
FINISH		

FUYOU 广东富源兴业精密科技实业有限公司
Shenzhen FUYOU Precision Electronic Technology Co., Ltd.

SCALE	SHEET	REV.
1:1	1/2	A

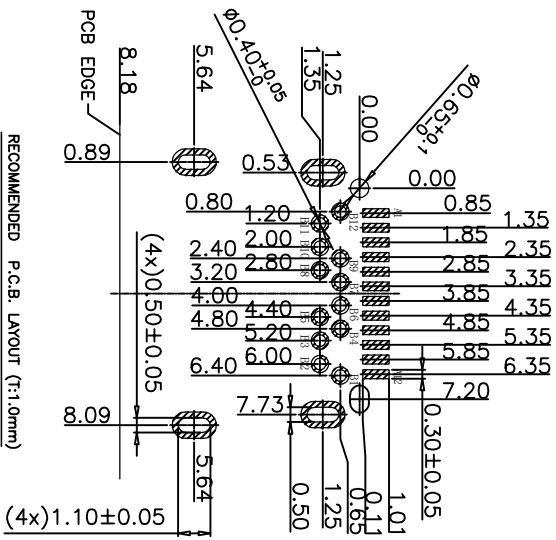

RECOMMENDED P.C.B. LAYOUT (T:1.0mm)
TOLERANCE UNSPECIFIED ±0.05mm

NOTE:

- 1.ELECTRICAL PERFORMANCE,
 - 1-1.CONTACT CURRENT RATING:
 - 3.0A FOR VBUS AND GND,VOLTAGE RATING:20V MAX.
 - (i.e., Pins A4,A9,B4,B9)
 - 1.25A FOR Vconn AND GND.
 - (i.e., Pins B5,A1,A12,B1,B12)
 - 0.25A FOR ALL THE OTHERS CONTACTS.
 - 1-2.INSULATION RESISTANCE:
 - 100MΩ MIN,AT 500VDC
 - 1-3.DIELECTRIC WITHSTAND VOLTAGE:
 - 100VAC(MIN.) FOR 1 MINUTE.
 - 1-4.LOW LEVEL CONTACT RESISTANCE:
 - INITIAL 40mΩ MAX.
 - AFTER 50mΩ MAX.
- 2.MECHANICAL CHARACTERISTICS:
 - 2-1.INSERTION FORCE:
 - 5N~20N
 - 2-2.EXTRACTION FORCE:
 - 8N~20N FROM 1 TO 1000 CYCLES
 - 6N~20N FROM 1001 TO 10000 CYCLE.
 - 2-3.DURABILITY: 10000 MATING CYCLES.
 - 2-4.OPERATING TEMPERATURE:
 - 30°C TO +80°C
- 3.REFLOW SOLDER CAPABLE TO 260°C 10 SECS
- 4.SALT SPRAY TEST:24H

USE TYPE-C FULL-FEATURED RECEPTACLE INTERFACE PIN ASSIGNMENTS

Pin	Signal Name	Description	Mating Sequence	Pin	Signal Name	Description	Mating Sequence
A1	GND	Ground return	First	B12	GND	Ground return	First
A2	SSRX1	Positive half of First SuperSpeed TX differential pair	Second	B11	SSRX1	Positive half of First SuperSpeed RX differential pair	Second
A3	SSRX1	Negative half of First SuperSpeed TX differential pair	Second	B10	SSRX1	Negative half of First SuperSpeed RX differential pair	Second
A4	Vbus	Bus Power	First	B9	Vbus	Bus Power	First
A5	CC1	Configuration Channel	Second	B8	SR02	Standalone Use (SR)	Second
A6	Dn1	Positive half of the USB 2.0 differential pair-Position 1	Second	E7	Dn2	Negative half of the USB 2.0 differential pair-Position 1	Second
A7	Dn1	Negative half of the USB 2.0 differential pair-Position 1	Second	B6	Dn2	Positive half of the USB 2.0 differential pair-Position 2	Second
A8	SBU1	Standalone Use (SBU)	Second	B5	CC2	Configuration Channel	Second
A9	Vbus	Bus Power	First	B4	Vbus	Bus Power	First
A10	SSRX2	Negative half of second SuperSpeed RX differential pair	Second	E3	SSRX2	Negative half of second SuperSpeed TX differential pair	Second
A11	SSRX2	Positive half of second SuperSpeed RX differential pair	Second	R2	SSRX2	Positive half of second SuperSpeed TX differential pair	Second
A12	GND	Ground return	First	B1	GND	Ground return	First

TOLERANCE		NAME(INTENDED USE)	
X.X ±0.30	X: ±10°	CUSTOMER DRAWING	
.XX ±0.20	.X: ±8°	PART NO.	
.XXX ±0.10	.XX: ±5°	FY23-687C24F1987-250 USB5.0 TYPE-C24P立贴8.8高频80G	
UNITS	mm	DESIGN:	ZXM
MATERILA	----	CHED:	
FINISH	-----	APPD:	

TITLE:		DRAWG NO.	
FY23-687C24F1987-250		FY23-687C24F1987-250	
SCALE	SHEET	REV.	
1:1	1/2	A	

FUYOU 广东富盈实业精密科技实业有限公司
Shenzhen FUYOU Precision Electronic Technology Co.,LTD.

REV.	ECN NO.	DESCRIPTION	DATE	DESIGN

1. 如图所示首先CARRIER TAPE (载带) 需先预留22PCS空格后方可置入成品, 并附COVER TPABE (上带) 覆盖于上, 再配合带装机自动卷绕于REEL (塑胶卷轴) 收料。
 As shown from picture, the initial starting carrier need to be emptied for 22 pcs, then put connector on 11th carrier; Then cover it with Cover Tape, and Reeling it with Reel auto machine.
 2. 在定量包装完成后, 前端CARRIER TAPE亦需预留22PCS空格, 而COVER TAPE配合CARRIER TYPE长度覆盖后, 并须再超出200mm以上, 最后以胶纸贴固, 并于REEL盘上方贴合格标签张。
 In the end of the Reel, need to empty 22 pcs carrier tape; After covering the carrier, then the Cover Tape need to be 200mm longer, and use tape to fix the cover tape to the reel. Put "Qualified label" on the Reel.
 3. 注意:COVER TAPE不可浮起或有贴附不响, 歪斜及成品放置方向错误之现象. 卷盘最外层需缠绕一圈保护带, 再按图示贴3处美纹胶. Attention: no deformation (prototruded plastic), or not smooth, bedut or product is wrong positioned). The out layer of the reel needs to be wound with a protective tape, and 3 places of masking tape are attached as shown in the figure.
 4. 在纸箱内左右, 前后侧各放入一块三角卡板, 把袋中装入10个REEL盘, 并在PE袋中放入2PCS干燥剂, 用胶布封好. 在每个纸箱内装入10PCS卷盘, 共1卷, 纸箱内上下各垫一张平卡, 盖上箱盖后以胶布封箱, 于侧位置贴出货标签一张. Inside of carton, at left and right side, put triangle fixed card; Put 10 Reels to PE bag, and put bags of desiccant inside the PE bag. Each carton has 10 reels. Put "Delivery Label" on side of the carton.
 5. 零箱部分, 出货时须用缓冲物填满。
 The fractional box must be filled by cushion before shipment.

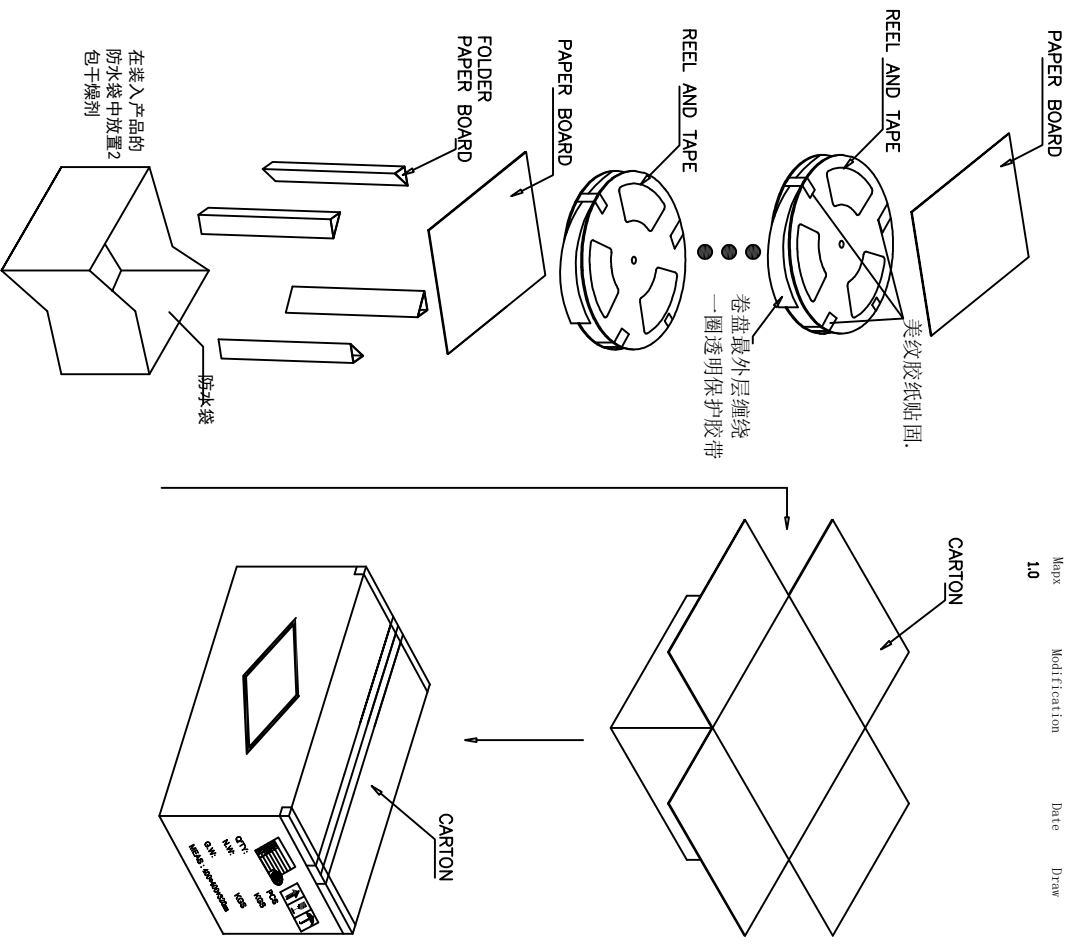
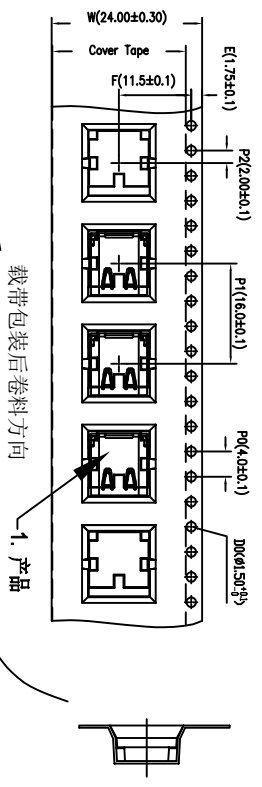
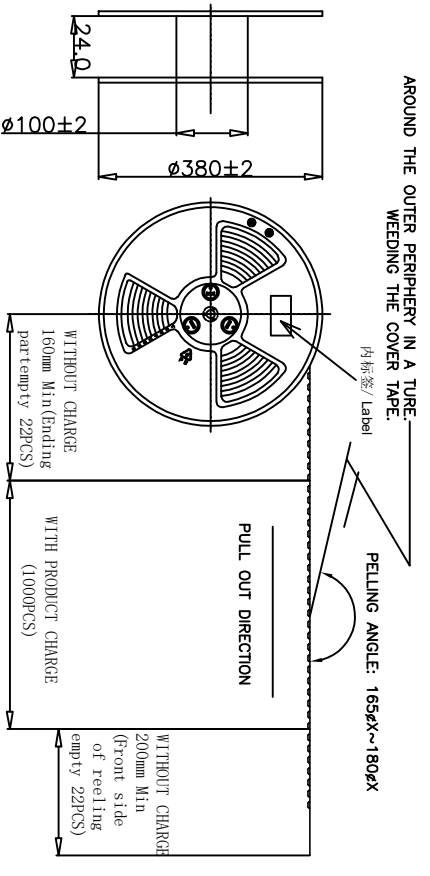

TOLERANCE		NAME (INTENDED USE)	
X.X ±0.30	X.X ±10°	CUSTOMER DRAWING	
XX ±0.20	X.X ± 8°	PART NO. FY23-68TC24F1987-250US5.0 TYPE-C24P 立贴8.8高 806	
.XXX ±0.10	.XX ± 5°	DESIGN: ZXM	
UNITS mm		DRAWG NO. FY23-68TC24F1987-250	
MATERILA		CHED:	
FINISH		APPD:	

FUYOU 广东富盈实业精密科技实业有限公司
 Guangdong FUYOU Precision Electronic Technology Co., Ltd.