

CUSTOMER

REV.	ECN NO.	DESCRIPTION	DATE	DESIGN

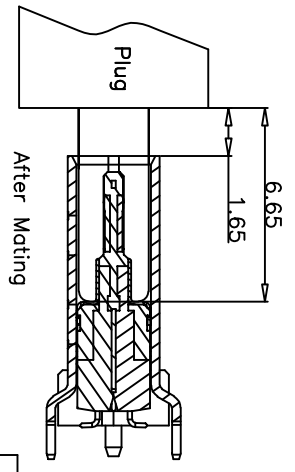
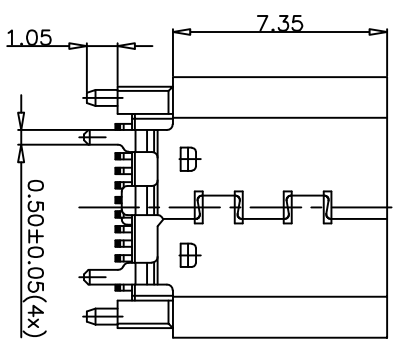
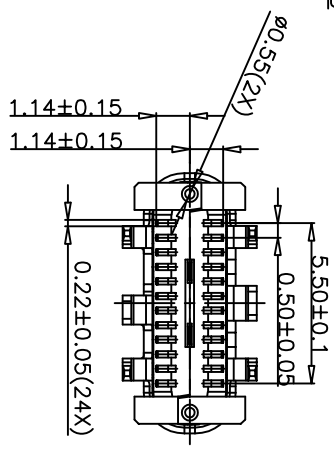
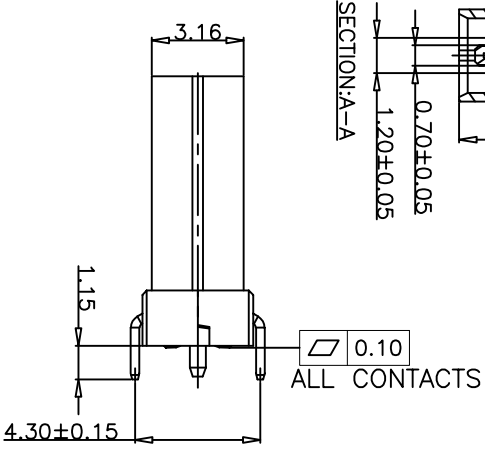
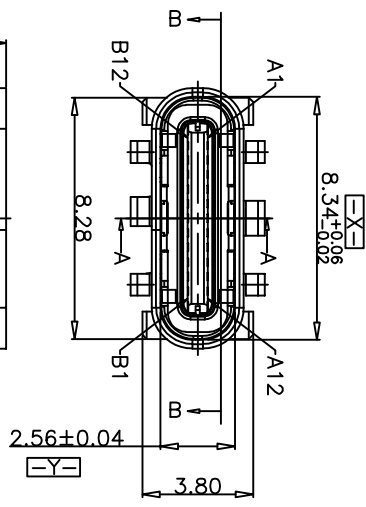
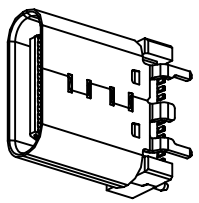
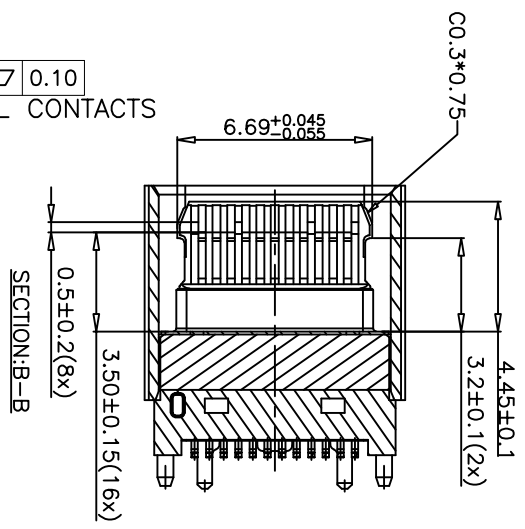
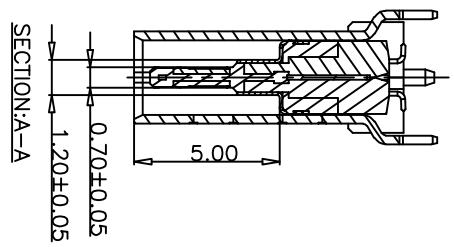
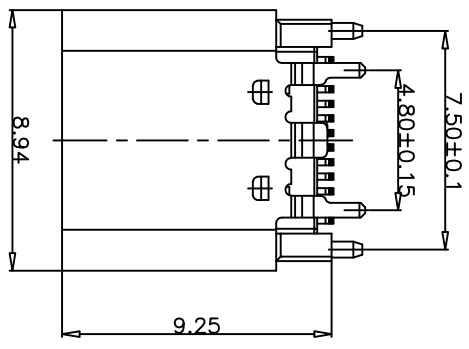

NO.	PART NAME	MATERIAL	FINISH
5	GROUND	STAINLESS STEEL	CLEAN
4	MID-PLATE	STAINLESS STEEL	CLEAN
3	OUTER SHELL	STAINLESS STEEL	UNDER PLATED: 30u" Au (G/P) SOLDER PALL.
2	CONTACTS	COPPER ALLOY	BLACK, UL 94V-0
1	HOUSING	LCP	BLACK, UL 94V-0

TOLERANCE		NAME (INTENDED USE)	
X.X ±0.30	X.X ±10°	CUSTOMER DRAWING	
XX ±0.20	X.X ±8°	TITLE: CF 24P 立贴9.3H 40G	
.XXX ±0.10	.XX ±5°	DRAWG NO. FY23-68TC24F493-01	
UNITS mm		SCALE 1:1	
MATERILA		SHEET 1/2	
FINISH		REV. A	

广东富盈兴业精密科技实业有限公司
 Guangdong FY20U Precision Electronic Technology Co., Ltd.

REV. ECN NO.	DESCRIPTION	DATE	DESIGN

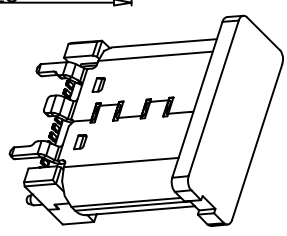
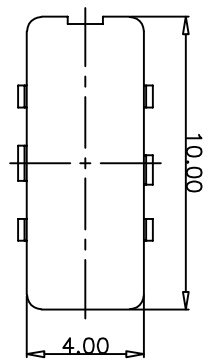

WITH PICK UP COVER

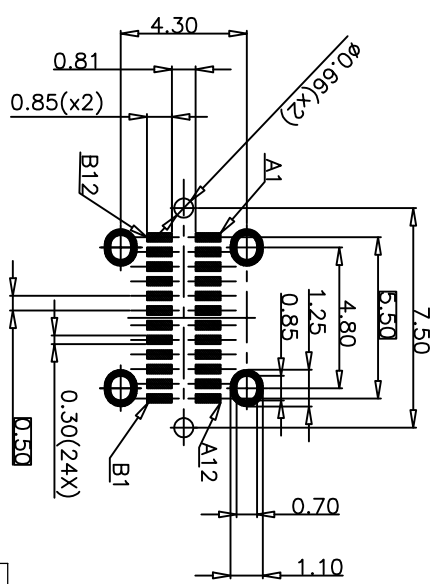

RECOMMENDED PCB LAYOUT(TOP VIEW)

THICKNESS 1.5±0.10mm;DEFAULT TOLERANCE:±0.05

USB TYPE-C FULL-FEATURED RECEPTACLE INTERFACE PIN ASSIGNMENTS

Pin	Signal Name	Description	Mating Sequence	Pin	Signal Name	Description	Mating Sequence
A1	GND	Ground return	First	B12	GND	ground return	First
A2	SSTXp1	Positive half of first SuperSpeed TX differential pair	Second	B11	SSRXp1	Positive half of first SuperSpeed RX differential pair	Second
A3	SSFXn1	Negative half of first SuperSpeed TX differential pair	Second	B10	SSRXn1	Negative half of first SuperSpeed RX differential pair	Second
A4	Vbus	Bus Power	First	B9	Vbus	Bus Power	First
A5	CC1	Configuration Channel	Second	B8	SBU2	Sideband Use (SBU)	Second
A6	Dp1	Positive half of the USB 2.0 differential pair-Position 1	Second	B7	Dm2	Negative half of the USB 2.0 differential pair-Position 2	Second
A7	Dn1	Negative half of the USB 2.0 differential pair-Position 1	Second	B6	Dp2	Positive half of the USB 2.0 differential pair-Position 2	Second
A8	SBU1	Sideband Use (SBU)	Second	B5	CC2	Configuration Channel	Second
A9	Vbus	bus Power	First	B4	Vbus	Bus Power	First
A10	SSRXn2	Negative half of second SuperSpeed RX differential pair	Second	B3	SSTXn2	Negative half of second SuperSpeed TX differential pair	Second
A11	SSRXp2	Positive half of second SuperSpeed RX differential pair	Second	B2	SSTXp2	Positive half of second SuperSpeed TX differential pair	Second
A12	GND	Ground return	First	B1	GND	ground return	First

- NOTE:
- ELECTRICAL PERFORMANCE:
 - CONTACT CURRENT RATING: 3.0A FOR VBUS AND GND.VOLTAGE RATING:5V (i.e., Pins A4,A9,B4,B9)
 - 1.25A FOR Vconn AND GND. (i.e., Pins B5,A1,A12,B1,B12)
 - 0.25A FOR ALL THE OTHERS CONTACTS.
 - INSULATION RESISTANCE: 100MΩ MIN.AT 100VDC
 - DIELECTRIC WITHSTAND VOLTAGE: 100VAC(MIN.) FOR 1 MINUTE.
 - LOW LEVEL CONTACT RESISTANCE: INITIAL 40mΩ MAX. AFTER 50mΩ MAX.
2. MECHANICAL CHARACTERISTICS:
- INSERTION FORCE: 5N~20N
 - EXTRACTION FORCE: 8N~20N FROM 1 TO 1000 CYCLES 6N~20N FROM 1001 TO 10000 CYCLE.
 - DURABILITY: 10000 MATING CYCLES.
 - OPERATING TEMPERATURE: -30°C TO +80°C.
3. REFLOW SOLDER CAPABLE TO 260°C 10 SECS
4. SALT SPRAY TEST:24H

TOLERANCE		NAME(INTENDED USE)	
X.X ±0.30	X. ±10'	CUSTOMER DRAWING	
.XX ±0.20	.X. ±8'	PART NO.	TY23-68TC24F493-01
.XXX ±0.10	.XX. ±5'	DESIGN:	ZXM
UNITS	mm	CHEG:	
MATERILA	----	APPD:	
FINISH	-----	DRAWG NO.	TY23-68TC24F493-01
		SCALE	1:1
		SHEET	1/2
		REV.	A



CF 24P 立贴9.3H 40G

REV.	ECN NO.	DESCRIPTION	DATE	DESIGN

1. 如图所示首先CARRIER TAPE (载体) 需先预留18PCS空格后方可置入成品, 并附COVER TPAB (上带) 覆盖于上, 再配合带装机自动卷绕于REEL (塑胶卷轴) 收料。

As shown from picture, the initial starting carrier need to be emptied for 18 pcs, then put connector on Inth carrier; Then cover it with Cover Tape, and Reeling it with Reel auto machine.

2. 在定量包装完成后, 前端CARRIER TAPE亦需预留18PCS空格, 而COVER TPAB配合CARRIER TYPE长度覆盖后, 并须再超出200mm以上, 最后以胶纸贴固, 并于REEL盖上方贴合格标签一张。

In the end of the Reel, need to empty 18 pcs carrier tape; After covering the carrier, then the Cover Tape need to be 200mm longer, and use tape to fix the cover tape to the reel. Put "Qualified label" on the Reel.

3. 注意: COVER TAPE不可浮起或有贴附不顺, 歪斜及成品放置方向错误之现象, 卷盘最外层需缠绕一圈保护带, 再按图示贴3处美纹胶。Attention: no deformation of Cover Tape is allowed (protruded plastic, or not smooth, bebt or product is wrong positioned), The out layer of the reel needs to be wound with a protective tape, and 3 places of masking tape are attached as shown in the figure.

4. 在纸箱内左右, 前后侧各放入一块三角卡板, 每个PE袋中装入5个REEL盘, 并在PE袋中放入2PCS干燥剂, 用胶带到好, 在每个纸箱内装入10PCS卷盘, 共2叠, 纸箱内上下各垫一张平卡, 盖上箱盖后以胶带封箱, 于侧位置贴出货标签一张; Inside of carton, at left and right side, put triangle fixed card; Put 5 Reels to PE bag, and put 2bags of desiccant inside the PE bag. Each carton has 10 reels. Put "Delivery label" on side of the carton.

5. 零箱部分, 出货时须用缓冲物填满。
The fractional box must be filled by cushion before shipment.

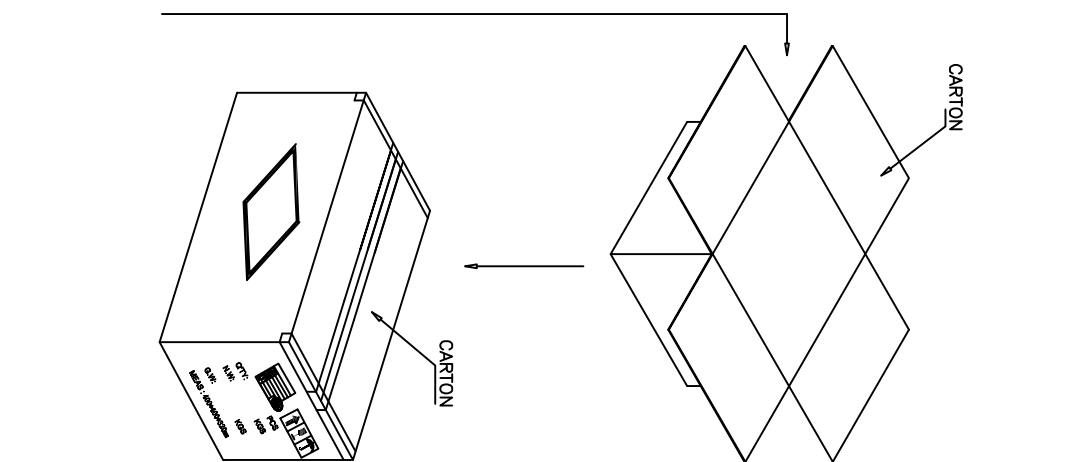
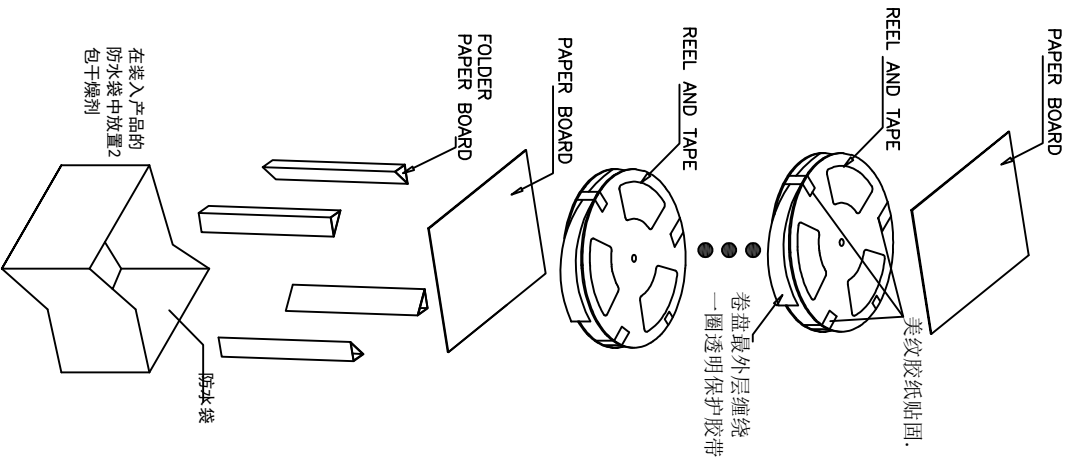
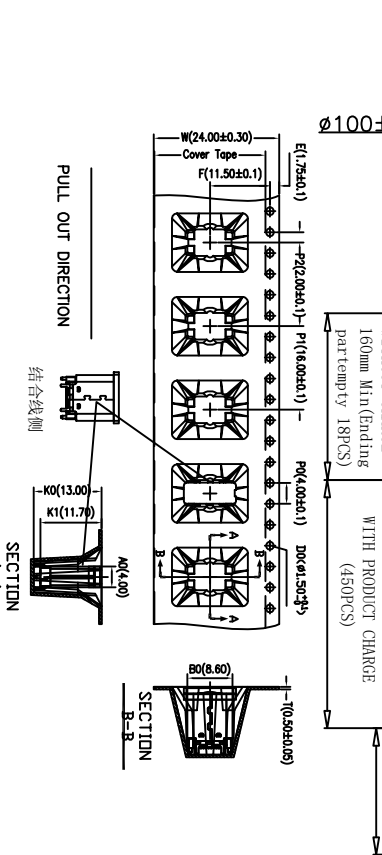
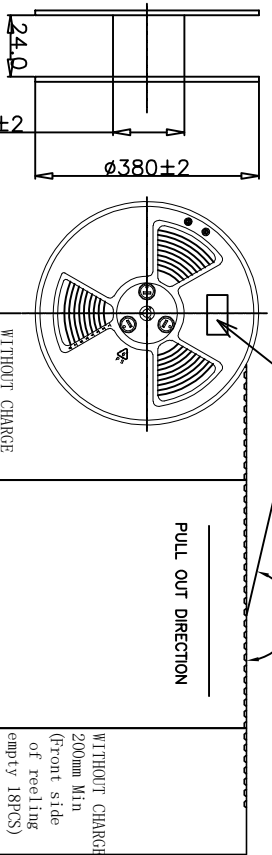

TOLERANCE		NAME (INTENDED USE)	
X.X ±0.30	X.X ±10°	CUSTOMER DRAWING	
XX ±0.20	X.X ± 8°	PART NO.	TITLE:
.XXX ±0.10	.XX ± 5°	FY23-68TC24F493-01	CF 24P立贴9.3H 40G
UNITS	mm	DESIGN:	ZXM
MATERILA	---	CHED:	---
FINISH	---	APPD:	---

FUYOU 广东富盈实业精密科技实业有限公司
Guangdong FUYOU Precision Electronic Technology Co., Ltd.

DRAWG NO.	FY23-68TC24F493-01
SCALE	1:1
SHEET	1/2
REV.	A